

Handling and Care

Interior Door

1 800.567.2931
T 819.535.5588
F 819.535.1104

M
Millette
portes·doors

www.portesmillette.com

HANDLING AND CARE INSTRUCTIONS

1. Do not remove plastic on the glass before painting french doors with wood moulding.
2. Put adhesive tape on all glass for the following doors: tempered glass, leaded lite as well as single or double glazed glass for exterior doors, since there is no plastic on the glass.
3. Lightly sand entire surface of the door with # 320 grit sand paper to remove any oils, dirt or marks. (Sand in direction of wood grain)
4. AVOID WATER BASE PRODUCTS. We recommend the following finish:
 - a) Paint : 1st coat of oil primer
 - b) Varnish: oil base
 - c) Stain : oil or solvent base.
5. Apply paint, stain or varnish in the wood grain direction. Finish all six sides including under hinges.
6. Follow all instructions recommended from the painting, staining or varnishing manufacturer.
7. After painting, staining or varnishing door, cut along perimeter of glass with a sharp utility knife. To remove plastic, place a straight smooth edge against glass, peel-off one corner and pull plastic towards you (see figure 1)

* See special instructions if needed in the section «Warranty»
8. Repeat this step on opposite side of glass and all other panes of glass.
9. For panel doors, make small incisions along edge of each panel and the surrounding moulding, after treating door. Failure to this will result in a chipped, warped or cracked panels (see figure 2).
10. Repeat on both sides of panel.

FIGURE 1

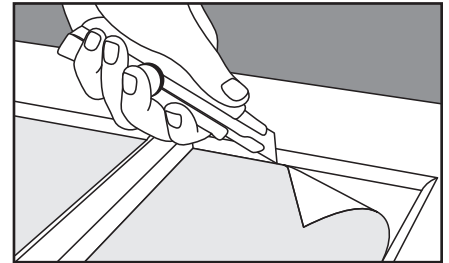
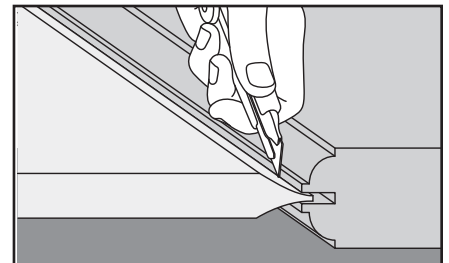

FIGURE 2



Handling and Care

Exterior Door

1 800.567.2931
T 819.535.5588
F 819.535.1104

M
Milette
portes·doors

www.portesmilette.com

HANDLING AND CARE INSTRUCTIONS

1. Paint, stain or varnish the six (6) faces of your door (and your frame if door is prehung) within seven days after purchase and before installation. Remove hinges and door sweep then apply paint, stain or varnish.
2. Before treating an exterior door with glass, make sure to put adhesive tape on the perimeter of all glass. They have no plastic protection on them.
3. Lightly sand entire surface of the door with # 320 grit sand paper to remove any oil, dirt or marks. (Sand in direction of wood grain).
4. Only use exterior finishing products. **AVOID WATER BASED PRODUCTS.** We recommend the following finish :
 - a) Paint 1st coat of oil primer,
 - b) Varnish: oil base,
 - c) Stain : oil or solvent base.

Note that the door must be treated before installation and once a year.

5. Apply paint, stain or varnish in the wood grain direction. Finish all six sides of the door.
6. Follow all instructions recommended from the painting, staining or varnishing manufacturer.
7. For panel doors, make small incisions along the edge of each panel and the surrounding moulding. Once finishing product has dried, make small incisions along the edge of each panel and surrounding moulding (see figure 1). Failure to this will result in a chipped, warped or cracked panels. For best weather proofing on doors, apply silicone on the perimeter of each panel on exterior side after making the incision around it (see figure 2).
8. Repeat on both sides of door.
9. You must protect this door from extreme weather conditions. Therefore, door must be installed under a 4^{ft} roof overhang.

RECOMMENDATIONS DURING WINTER CONDITIONS

If your door was purchased and transported during temperatures below -1°C., unwrap as soon as possible to avoid condensation. It must then be stored in an area with temperature between 18°C and 22°C and humidity level between 35% and 65% for 24 to 48 hours. Before applying paint, stain or varnish, it is strongly recommended to test on a small piece of wood for desired results. Always follow the recommendation from the finishing products manufacturer.

FIGURE 1

Wood panel door

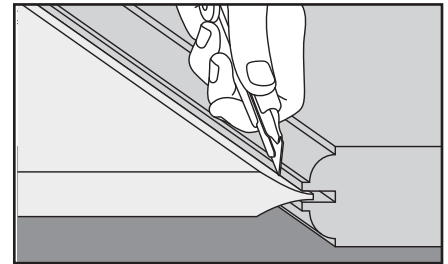

FIGURE 2

Exterior door

